

\* required information

## Section 1 of 21

You can save the form at any time and resume it later. You do not need to be logged in when you resume.

System reference

Not Currently In Use

This is the unique reference for this application generated by the system.

Your reference

RXA.HOL356.1

You can put what you want here to help you track applications if you make lots of them. It is passed to the authority.

Are you an agent acting on behalf of the applicant?

☒ Yes

☐ No

Put "no" if you are applying on your own behalf or on behalf of a business you own or work for.

### Applicant Details

\* First name

Suna

\* Family name

Miah

\* E-mail

Main telephone number

Include country code.

Other telephone number

☐ Indicate here if the applicant would prefer not to be contacted by telephone

Is the applicant:

☐ Applying as a business or organisation, including as a sole trader

☒ Applying as an individual

A sole trader is a business owned by one person without any special legal structure. Applying as an individual means the applicant is applying so the applicant can be employed, or for some other personal reason, such as following a hobby.

Continued from previous page...

### Address

* Building number or name	<input type="text"/>
* Street	<input type="text"/>
District	<input type="text"/>
* City or town	<input type="text"/>
County or administrative area	<input type="text"/>
* Postcode	<input type="text"/>
* Country	<input type="text" value="United Kingdom"/>

### Agent Details

* First name	<input type="text" value="Richard"/>
* Family name	<input type="text" value="Arnot"/>
* E-mail	<input type="text"/>
Main telephone number	<input data-bbox="491 1025 1032 1070" type="text" value="( "/>
Other telephone number	<input type="text"/>

Include country code.

☐ Indicate here if you would prefer not to be contacted by telephone

Are you:

- ☒ An agent that is a business or organisation, including a sole trader  
☐ A private individual acting as an agent

A sole trader is a business owned by one person without any special legal structure.

### Agent Business

Is your business registered in the UK with Companies House? ☒ Yes ☐ No

Note: completing the Applicant Business section is optional in this form.

Registration number	<input type="text" value="OC430614"/>
Business name	<input type="text" value="Ward Hadaway LLP"/>
VAT number	<input type="text" value="GB 176080853"/>
Legal status	<input type="text" value="Limited Liability Partnership"/>
Your position in the business	<input type="text" value="Partner"/>
Home country	<input type="text" value="United Kingdom"/>

If your business is registered, use its registered name.

Put "none" if you are not registered for VAT.

The country where the headquarters of your business is located.

Continued from previous page...

**Agent Registered Address**

Address registered with Companies House.

Building number or name	Sandgate House
Street	102 Quayside
District	
City or town	Newcastle upon Tyne
County or administrative area	
Postcode	NE1 3DX
Country	United Kingdom

**Section 2 of 21**

**PREMISES DETAILS**

I/we, as named in section 1, apply for a premises licence under section 17 of the Licensing Act 2003 for the premises described in section 2 below (the premises) and I/we are making this application to you as the relevant licensing authority in accordance with section 12 of the Licensing Act 2003.

**Premises Address**

Are you able to provide a postal address, OS map reference or description of the premises?

☒ Address    ☐ OS map reference    ☐ Description

**Postal Address Of Premises**

Building number or name	Rialto
Street	1 Main Street and land adjacent thereto ref NZ 16600 72807
District	
City or town	Ponteland
County or administrative area	
Postcode	NE20 9NH
Country	United Kingdom

**Further Details**

Telephone number	
Non-domestic rateable value of premises (£)	33,750

### Section 3 of 21

#### APPLICATION DETAILS

In what capacity are you applying for the premises licence?

- ☒ An individual or individuals
- ☐ A limited company / limited liability partnership
- ☐ A partnership (other than limited liability)
- ☐ An unincorporated association
- ☐ Other (for example a statutory corporation)
- ☐ A recognised club
- ☐ A charity
- ☐ The proprietor of an educational establishment
- ☐ A health service body
- ☐ A person who is registered under part 2 of the Care Standards Act 2000 (c14) in respect of an independent hospital in Wales
- ☐ A person who is registered under Chapter 2 of Part 1 of the Health and Social Care Act 2008 in respect of the carrying on of a regulated activity (within the meaning of that Part) in an independent hospital in England
- ☐ The chief officer of police of a police force in England and Wales

#### Confirm The Following

- ☒ I am carrying on or proposing to carry on a business which involves the use of the premises for licensable activities
- ☐ I am making the application pursuant to a statutory function
- ☐ I am making the application pursuant to a function discharged by virtue of Her Majesty's prerogative

### Section 4 of 21

#### INDIVIDUAL APPLICANT DETAILS

##### Applicant Name

Is the name the same as (or similar to) the details given in section one?

- ☒ Yes ☐ No

If "Yes" is selected you can re-use the details from section one, or amend them as required. Select "No" to enter a completely new set of details.

First name

Family name

Is the applicant 18 years of age or older?

- ☒ Yes ☐ No

Continued from previous page...

### Current Residential Address

Is the address the same as (or similar to) the address given in section one?

If "Yes" is selected you can re-use the details from section one, or amend them as required. Select "No" to enter a completely new set of details.

☒ Yes

☐ No

Building number or name

Street

District

City or town

County or administrative area

Postcode

Country

### Applicant Contact Details

Are the contact details the same as (or similar to) those given in section one?

If "Yes" is selected you can re-use the details from section one, or amend them as required. Select "No" to enter a completely new set of details.

☒ Yes

☐ No

E-mail

Telephone number

Other telephone number

\* Date of birth

 /  / 

dd mm yyyy

\* Nationality

British

Documents that demonstrate entitlement to work in the UK

Right to work share code

Right to work share code if not submitting scanned documents

Add another applicant

### Section 5 of 21

#### OPERATING SCHEDULE

When do you want the premises licence to start?

 /  / 

dd mm yyyy

If you wish the licence to be valid only for a limited period, when do you want it to end

 /  / 

dd mm yyyy

Provide a general description of the premises



**Continued from previous page...**

For example the type of premises, its general situation and layout and any other information which could be relevant to the licensing objectives. Where your application includes off-supplies of alcohol and you intend to provide a place for consumption of these off-supplies you must include a description of where the place will be and its proximity to the premises.

The internal area shall continue to trade in the style of a restaurant.

The external area shall provide facilities for the consumption of alcohol, entertainment and food.

If 5,000 or more people are expected to attend the premises at any one time, state the number expected to attend

#### **Section 6 of 21**

##### **PROVISION OF PLAYS**

[See guidance on regulated entertainment](#)

Will you be providing plays?

☐ Yes

☒ No

#### **Section 7 of 21**

##### **PROVISION OF FILMS**

[See guidance on regulated entertainment](#)

Will you be providing films?

☐ Yes

☒ No

#### **Section 8 of 21**

##### **PROVISION OF INDOOR SPORTING EVENTS**

[See guidance on regulated entertainment](#)

Will you be providing indoor sporting events?

☐ Yes

☒ No

#### **Section 9 of 21**

##### **PROVISION OF BOXING OR WRESTLING ENTERTAINMENTS**

[See guidance on regulated entertainment](#)

Will you be providing boxing or wrestling entertainments?

☐ Yes

☒ No

#### **Section 10 of 21**

##### **PROVISION OF LIVE MUSIC**

[See guidance on regulated entertainment](#)

Will you be providing live music?

☒ Yes

☐ No

##### **Standard Days And Timings**

Continued from previous page...

MONDAY

Start 11:00

End 00:00

Start

End

Give timings in 24 hour clock.  
(e.g., 16:00) and only give details for the days  
of the week when you intend the premises  
to be used for the activity.

TUESDAY

Start 11:00

End 00:00

Start

End

WEDNESDAY

Start 11:00

End 00:00

Start

End

THURSDAY

Start 11:00

End 00:00

Start

End

FRIDAY

Start 11:00

End 00:00

Start

End

SATURDAY

Start 11:00

End 00:00

Start

End

SUNDAY

Start 11:00

End 00:00

Start

End

Will the performance of live music take place indoors or outdoors or both?

☐ Indoors

☐ Outdoors

☒ Both

Where taking place in a building or other  
structure tick as appropriate. Indoors may  
include a tent.

State type of activity to be authorised, if not already stated, and give relevant further details, for example (but not  
exclusively) whether or not music will be amplified or unamplified.

State any seasonal variations for the performance of live music

For example (but not exclusively) where the activity will occur on additional days during the summer months.

Continued from previous page...

Non-standard timings. Where the premises will be used for the performance of live music at different times from those listed in the column on the left, list below

For example (but not exclusively), where you wish the activity to go on longer on a particular day e.g. Christmas Eve.

Live Music outdoors shall end at 20:30 Monday to Thursday and 21:30 Friday, Saturday, Sunday and on Bank Holidays

## Section 11 of 21

### PROVISION OF RECORDED MUSIC

[See guidance on regulated entertainment](#)

Will you be providing recorded music?

☒ Yes

☐ No

#### Standard Days And Timings

##### MONDAY

Start

End

Start

End

##### TUESDAY

Start

End

Start

End

##### WEDNESDAY

Start

End

Start

End

##### THURSDAY

Start

End

Start

End

##### FRIDAY

Start

End

Start

End

##### SATURDAY

Start

End

Start

End

Give timings in 24 hour clock.  
(e.g., 16:00) and only give details for the days  
of the week when you intend the premises  
to be used for the activity.



Continued from previous page...

SUNDAY

Start 11:00

End 00:00

Start

End

Will the playing of recorded music take place indoors or outdoors or both?

Where taking place in a building or other structure tick as appropriate. Indoors may include a tent.

☐ Indoors ☐ Outdoors ☒ Both

State type of activity to be authorised, if not already stated, and give relevant further details, for example (but not exclusively) whether or not music will be amplified or unamplified.

State any seasonal variations for playing recorded music

For example (but not exclusively) where the activity will occur on additional days during the summer months.

Non-standard timings. Where the premises will be used for the playing of recorded music at different times from those listed in the column on the left, list below

For example (but not exclusively), where you wish the activity to go on longer on a particular day e.g. Christmas Eve.

Recorded Music outdoors shall end at 22:30 Monday - Sunday

## Section 12 of 21

### PROVISION OF PERFORMANCES OF DANCE

[See guidance on regulated entertainment](#)

Will you be providing performances of dance?

☐ Yes ☒ No

## Section 13 of 21

### PROVISION OF ANYTHING OF A SIMILAR DESCRIPTION TO LIVE MUSIC, RECORDED MUSIC OR PERFORMANCES OF DANCE

[See guidance on regulated entertainment](#)

Will you be providing anything similar to live music, recorded music or performances of dance?

☐ Yes ☒ No

## Section 14 of 21

### LATE NIGHT REFRESHMENT

Will you be providing late night refreshment?

Continued from previous page...

### Standard Days And Timings

#### MONDAY

Start 23:00

End 00:00

Start

End

Give timings in 24 hour clock.  
(e.g., 16:00) and only give details for the day  
of the week when you intend the premises  
to be used for the activity.

#### TUESDAY

Start 23:00

End 00:00

Start

End

#### WEDNESDAY

Start 23:00

End 00:00

Start

End

#### THURSDAY

Start 23:00

End 00:00

Start

End

#### FRIDAY

Start 23:00

End 00:00

Start

End

#### SATURDAY

Start 23:00

End 00:00

Start

End

#### SUNDAY

Start 23:00

End 00:00

Start

End

Will the provision of late night refreshment take place indoors or outdoors or both?

☐ Indoors

☐ Outdoors

☒ Both

Where taking place in a building or other structure tick as appropriate. Indoors may include a tent.

State type of activity to be authorised, if not already stated, and give relevant further details, for example (but not exclusively) whether or not music will be amplified or unamplified.

State any seasonal variations

Continued from previous page...

For example (but not exclusively) where the activity will occur on additional days during the summer months.

Non-standard timings. Where the premises will be used for the supply of late night refreshments at different times from those listed in the column on the left, list below

For example (but not exclusively), where you wish the activity to go on longer on a particular day e.g. Christmas Eve.

Late Night Refreshment shall only be permitted in the external area on Friday and Saturday to 23:30

## Section 15 of 21

### SUPPLY OF ALCOHOL

Will you be selling or supplying alcohol?

☒ Yes

☐ No

#### Standard Days And Timings

##### MONDAY

Start

End

Start

End

Give timings in 24 hour clock.  
(e.g., 16:00) and only give details for the days  
of the week when you intend the premises  
to be used for the activity.

##### TUESDAY

Start

End

Start

End

##### WEDNESDAY

Start

End

Start

End

##### THURSDAY

Start

End

Start

End

##### FRIDAY

Start

End

Start

End

##### SATURDAY

Start

End

Start

End

Continued from previous page...

SUNDAY

Start 11:00

End 00:00

Start

End

Will the sale of alcohol be for consumption:

☐ On the premises ☐ Off the premises ☒ Both

If the sale of alcohol is for consumption on the premises select on, if the sale of alcohol is for consumption away from the premises select off. If the sale of alcohol is for consumption on the premises and away from the premises select both.

State any seasonal variations

For example (but not exclusively) where the activity will occur on additional days during the summer months.

Non-standard timings. Where the premises will be used for the supply of alcohol at different times from those listed in the column on the left, list below

For example (but not exclusively), where you wish the activity to go on longer on a particular day e.g. Christmas Eve.

Alcohol may be supplied for consumption in the external area to 22:30 Sunday to Thursday and to 23:00 Friday and Saturday

State the name and details of the individual whom you wish to specify on the licence as premises supervisor

**Name**

First name Suna

Family name Miah

Date of birth  /  /   
dd mm yyyy

Continued from previous page...

**Enter the contact's address**

Building number or name	<input type="text"/>
Street	<input type="text"/>
District	<input type="text"/>
City or town	<input type="text"/>
County or administrative area	<input type="text"/>
Postcode	<input type="text"/>
Country	<input type="text" value="United Kingdom"/>
Personal Licence number (if known)	<input type="text" value="NPL/499"/>
Issuing licensing authority (if known)	<input type="text" value="Northumberland County Council"/>

**PROPOSED DESIGNATED PREMISES SUPERVISOR CONSENT**

How will the consent form of the proposed designated premises supervisor be supplied to the authority?

- ☐ Electronically, by the proposed designated premises supervisor
- ☒ As an attachment to this application

Reference number for consent form (if known)

If the consent form is already submitted, ask the proposed designated premises supervisor for its 'system reference' or 'your reference'.

**Section 16 of 21**

**ADULT ENTERTAINMENT**

Highlight any adult entertainment or services, activities, or other entertainment or matters ancillary to the use of the premises that may give rise to concern in respect of children

Give information about anything intended to occur at the premises or ancillary to the use of the premises which may give rise to concern in respect of children, regardless of whether you intend children to have access to the premises, for example (but not exclusively) nudity or semi-nudity, films for restricted age groups etc gambling machines etc.

NONE

**Section 17 of 21**

**HOURS PREMISES ARE OPEN TO THE PUBLIC**

**Standard Days And Timings**

MONDAY

Start

End

Start

End

Give timings in 24 hour clock. (e.g., 16:00) and only give details for the days of the week when you intend the premises to be used for the activity.



Continued from previous page...

TUESDAY

Start 11:00

End 00:00

Start

End

WEDNESDAY

Start 11:00

End 00:00

Start

End

THURSDAY

Start 11:00

End 00:00

Start

End

FRIDAY

Start 11:00

End 00:00

Start

End

SATURDAY

Start 11:00

End 00:00

Start

End

SUNDAY

Start 11:00

End 00:00

Start

End

State any seasonal variations

For example (but not exclusively) where the activity will occur on additional days during the summer months.

Non standard timings. Where you intend to use the premises to be open to the members and guests at different times from those listed in the column on the left, list below

For example (but not exclusively), where you wish the activity to go on longer on a particular day e.g. Christmas Eve.

The external area opening hours are Sunday to Thursday 11:00-23:00 and Friday and Saturday 11:00-23:30

Section 18 of 21

LICENSING OBJECTIVES

Describe the steps you intend to take to promote the four licensing objectives:

a) General – all four licensing objectives (b,c,d,e)

**Continued from previous page...**

List here steps you will take to promote all four licensing objectives together.

Having had regard to the nature of the application and the locality and having had discussions with the Police, the attached schedule of conditions is appropriate and proportionate

b) The prevention of crime and disorder

see attached

c) Public safety

see attached

d) The prevention of public nuisance

see attached

e) The protection of children from harm

see attached

**Section 19 of 21**

**NOTES ON DEMONSTRATING ENTITLEMENT TO WORK IN THE UK**

*Continued from previous page...*

**Entitlement to work/immigration status for individual applicants and applications from partnerships which are not limited liability partnerships:**

A licence may not be held by an individual or an individual in a partnership who is resident in the UK who:

- does not have the right to live and work in the UK; or
- is subject to a condition preventing him or her from doing work relating to the carrying on of a licensable activity.

Any premises licence issued in respect of an application made on or after 6 April 2017 will become invalid if the holder ceases to be entitled to work in the UK.

Applicants must demonstrate that they have an entitlement to work in the UK and are not subject to a condition preventing them from doing work relating to the carrying on of a licensable activity. They do this in one of two ways: 1) by providing with this application copies or scanned copies of the documents listed below (which do not need to be certified), or 2) by providing their 'share code' to enable the licensing authority to carry out a check using the Home Office online right to work checking service (see below).

**Documents which demonstrate entitlement to work in the UK**

- An expired or current passport showing the holder, or a person named in the passport as the child of the holder, is a British citizen or a citizen of the UK and Colonies having the right of abode in the UK [please see note below about which sections of the passport to copy].
- An expired or current passport or national identity card showing the holder, or a person named in the passport as the child of the holder, is a national of a European Economic Area country or Switzerland.
- A Registration Certificate or document certifying permanent residence issued by the Home Office to a national of a European Economic Area country or Switzerland.
- A Permanent Residence Card issued by the Home Office to the family member of a national of a European Economic Area country or Switzerland.
- A **current** Biometric Immigration Document (Biometric Residence Permit) issued by the Home Office to the holder indicating that the person named is allowed to stay indefinitely in the UK, or has no time limit on their stay in the UK.
- A **current** passport endorsed to show that the holder is exempt from immigration control, is allowed to stay indefinitely in the UK, has the right of abode in the UK, or has no time limit on their stay in the UK.
- A **current** Immigration Status Document issued by the Home Office to the holder with an endorsement indicating that the named person is allowed to stay indefinitely in the UK or has no time limit on their stay in the UK, **when produced in combination with** an official document giving the person's permanent National Insurance number and their name issued by a Government agency or a previous employer.
- A birth or adoption certificate issued in the UK, **when produced in combination with** an official document giving the person's permanent National Insurance number and their name issued by a Government agency or a previous employer.
- A birth or adoption certificate issued in the Channel Islands, the Isle of Man or Ireland **when produced in combination with** an official document giving the person's permanent National Insurance number and their name issued by a Government agency or a previous employer.
- A certificate of registration or naturalisation as a British citizen, **when produced in combination with** an official document giving the person's permanent National Insurance number and their name issued by a Government agency or a previous employer.

*Continued from previous page...*

- A **current** passport endorsed to show that the holder is allowed to stay in the UK and is currently allowed to work and is not subject to a condition preventing the holder from doing work relating to the carrying on of a licensable activity.
- A **current** Biometric Immigration Document (Biometric Residence Permit) issued by the Home Office to the holder which indicates that the named person can currently stay in the UK and is allowed to work relation to the carrying on of a licensable activity.
- A **current** Residence Card issued by the Home Office to a person who is not a national of a European Economic Area state or Switzerland but who is a family member of such a national or who has derivative rights or residence.
- A **current** Immigration Status Document containing a photograph issued by the Home Office to the holder with an endorsement indicating that the named person may stay in the UK, and is allowed to work and is not subject to a condition preventing the holder from doing work relating to the carrying on of a licensable activity **when produced in combination with** an official document giving the person's permanent National Insurance number and their name issued by a Government agency or a previous employer.
- A Certificate of Application, **less than 6 months old**, issued by the Home Office under regulation 18(3) or 20(2) of the Immigration (European Economic Area) Regulations 2016, to a person who is not a national of a European Economic Area state or Switzerland but who is a family member of such a national or who has derivative rights of residence.
- Reasonable evidence that the person has an outstanding application to vary their permission to be in the UK with the Home Office such as the Home Office acknowledgement letter or proof of postage evidence, or reasonable evidence that the person has an appeal or administrative review pending on an immigration decision, such as an appeal or administrative review reference number.
- Reasonable evidence that a person who is not a national of a European Economic Area state or Switzerland but who is a family member of such a national or who has derivative rights of residence in exercising treaty rights in the UK including:-
  - evidence of the applicant's own identity – such as a passport,
  - evidence of their relationship with the European Economic Area family member – e.g. a marriage certificate, civil partnership certificate or birth certificate, and
  - evidence that the European Economic Area national has a right of permanent residence in the UK or is one of the following if they have been in the UK for more than 3 months:
    - (i) working e.g. employment contract, wage slips, letter from the employer,
    - (ii) self-employed e.g. contracts, invoices, or audited accounts with a bank,
    - (iii) studying e.g. letter from the school, college or university and evidence of sufficient funds; or
    - (iv) self-sufficient e.g. bank statements.

Family members of European Economic Area nationals who are studying or financially independent must also provide evidence that the European Economic Area national and any family members hold comprehensive sickness insurance in the UK. This can include a private medical insurance policy, an EHIC card or an S1, S2 or S3 form.

**Original documents must not be sent to licensing authorities.** If the document copied is a passport, a copy of the following pages should be provided:-

- (i) any page containing the holder's personal details including nationality;
- (ii) any page containing the holder's photograph;
- (iii) any page containing the holder's signature;
- (iv) any page containing the date of expiry; and
- (v) any page containing information indicating the holder has permission to enter or remain in the UK and is permitted to work.



**Continued from previous page...**

If the document is not a passport, a copy of the whole document should be provided.

Your right to work will be checked as part of your licensing application and this could involve us checking your immigration status with the Home Office. We may otherwise share information with the Home Office. Your licence application will not be determined until you have complied with this guidance.

### **Home Office online right to work checking service**

As an alternative to providing a copy of the documents listed above, applicants may demonstrate their right to work by allowing the licensing authority to carry out a check with the Home Office online right to work checking service.

To demonstrate their right to work via the Home Office online right to work checking service, applicants should include in this application their 9-digit share code (provided to them upon accessing the service at <https://www.gov.uk/prove-right-to-work>) which, along with the applicant's date of birth (provided within this application), will allow the licensing authority to carry out the check.

In order to establish the applicant's right to work, the check will need to indicate that the applicant is allowed to work in the United Kingdom and is not subject to a condition preventing them from doing work relating to the carrying on of a licensable activity.

An online check will not be possible in all circumstances because not all applicants will have an immigration status that can be checked online. The Home Office online right to work checking service sets out what information and/or documentation applicants will need in order to access the service. Applicants who are unable to obtain a share code from the service should submit copy documents as set out above.

## **Section 20 of 21**

### **NOTES ON REGULATED ENTERTAINMENT**



**Continued from previous page...**

In terms of specific **regulated entertainments** please note that:

- **Plays:** no licence is required for performances between 08:00 and 23.00 on any day, provided that the audience does not exceed 500.
- **Films:** no licence is required for 'not-for-profit' film exhibition held in community premises between 08.00 and 23.00 on any day provided that the audience does not exceed 500 and the organiser (a) gets consent to the screening from a person who is responsible for the premises; and (b) ensures that each such screening abides by age classification ratings.
- **Indoor sporting events:** no licence is required for performances between 08.00 and 23.00 on any day, provided that the audience does not exceed 1000.
- **Boxing or Wrestling Entertainment:** no licence is required for a contest, exhibition or display of Greco-Roman wrestling, or freestyle wrestling between 08.00 and 23.00 on any day, provided that the audience does not exceed 1000. Combined fighting sports – defined as a contest, exhibition or display which combines boxing or wrestling with one or more martial arts – are licensable as a boxing or wrestling entertainment rather than an indoor sporting event.
- **Live music:** no licence permission is required for:
  - o a performance of unamplified live music between 08.00 and 23.00 on any day, on any premises.
  - o a performance of amplified live music between 08.00 and 23.00 on any day on premises authorised to sell alcohol for consumption on those premises, provided that the audience does not exceed 500.
  - o a performance of amplified live music between 08.00 and 23.00 on any day, in a workplace that is not licensed to sell alcohol on those premises, provided that the audience does not exceed 500.
  - o a performance of amplified live music between 08.00 and 23.00 on any day, in a church hall, village hall, community hall, or other similar community premises, that is not licensed by a premises licence to sell alcohol, provided that (a) the audience does not exceed 500, and (b) the organiser gets consent for the performance from a person who is responsible for the premises.
  - o a performance of amplified live music between 08.00 and 23.00 on any day, at the non-residential premises of (i) a local authority, or (ii) a school, or (iii) a hospital, provided that (a) the audience does not exceed 500, and (b) the organiser gets consent for the performance on the relevant premises from: (i) the local authority concerned, or (ii) the school or (iii) the health care provider for the hospital.
- **Recorded Music:** no licence permission is required for:
  - o any playing of recorded music between 08.00 and 23.00 on any day on premises authorised to sell alcohol for consumption on those premises, provided that the audience does not exceed 500.
  - o any playing of recorded music between 08.00 and 23.00 on any day, in a church hall, village hall, community hall, or other similar community premises, that is not licensed by a premises licence to sell alcohol, provided that (a) the audience does not exceed 500, and (b) the organiser gets consent for the performance from a person who is responsible for the premises.
  - o any playing of recorded music between 08.00 and 23.00 on any day, at the non-residential premises of (i) a local authority, or (ii) a school, or (iii) a hospital, provided that (a) the audience does not exceed 500, and (b) the organiser gets consent for the performance on the relevant premises from: (i) the local authority concerned, or (ii) the school proprietor or (iii) the health care provider for the hospital.

**Continued from previous page...**

- Dance: no licence is required for performances between 08.00 and 23.00 on any day, provided that the audience does not exceed 500. However, a performance which amounts to adult entertainment remains licensable.
- Cross activity exemptions: no licence is required between 08.00 and 23.00 on any day, with no limit on audience size for:
  - o any entertainment taking place on the premises of the local authority where the entertainment is provided by or on behalf of the local authority;
  - o any entertainment taking place on the hospital premises of the health care provider where the entertainment is provided by or on behalf of the health care provider;
  - o any entertainment taking place on the premises of the school where the entertainment is provided by or on behalf of the school proprietor; and
  - o any entertainment (excluding films and a boxing or wrestling entertainment) taking place at a travelling circus, provided that (a) it takes place within a moveable structure that accommodates the audience, and (b) that the travelling circus has not been located on the same site for more than 28 consecutive days.

## **Section 21 of 21**

### **PAYMENT DETAILS**

This fee must be paid to the authority. If you complete the application online, you must pay it by debit or credit card.

Premises Licence Fees are determined by the non-domestic rateable value of the premises.

To find out a premises non domestic rateable value go to the Valuation Office Agency site at [http://www.voa.gov.uk/business\\_rates/index.htm](http://www.voa.gov.uk/business_rates/index.htm)

Band A - No RV to £4300 £100.00

Band B - £4301 to £33000 £190.00

Band C - £33001 to £87000 £315.00

Band D - £87001 to £125000 £450.00\*

Band E - £125001 and over £635.00\*

\*If the premises rateable value is in Bands D or E and the premises is primarily used for the consumption of alcohol on the premises then you are required to pay a higher fee

Band D - £87001 to £125000 £900.00

Band E - £125001 and over £1,905.00

There is an exemption from the payment of fees in relation to the provision of regulated entertainment at church halls, chapel halls or premises of a similar nature, village halls, parish or community halls, or other premises of a similar nature. The costs associated with these licences will be met by central Government. If, however, the licence also authorises the use of the premises for the supply of alcohol or the provision of late night refreshment, a fee will be required.

Schools and sixth form colleges are exempt from the fees associated with the authorisation of regulated entertainment where the entertainment is provided by and at the school or college and for the purposes of the school or college.

If you operate a large event you are subject to ADDITIONAL fees based upon the number in attendance at any one time

Capacity 5000-9999 £1,000.00

Capacity 10000 -14999 £2,000.00

Capacity 15000-19999 £4,000.00

Capacity 20000-29999 £8,000.00

Capacity 30000-39999 £16,000.00

Capacity 40000-49999 £24,000.00

Capacity 50000-59999 £32,000.00

Capacity 60000-69999 £40,000.00

Capacity 70000-79999 £48,000.00

Capacity 80000-89999 £56,000.00

Capacity 90000 and over £64,000.00

\* Fee amount (£)

315.00

### **DECLARATION**

**Continued from previous page...**

- \* I/we understand it is an offence, liable on conviction to a fine up to level 5 on the standard scale, under section 158 of the licensing act 2003, to make a false statement in or in connection with this application.
  - I understand that I am required to advertise my application in a local newspaper or, if there is none, in a local newsletter,
  - \* circular or similar document, circulating in the vicinity of the premises, within 10 working days of my application being submitted to the Licensing Authority
  - \* I understand that I am required to advertise my application by posting a blue notice on the premises for 28 consecutive days commencing on, and including the day after the day when my application is given to the licensing authority.
- ☒ Ticking this box indicates you have read and understood the above declaration

This section should be completed by the applicant, unless you answered "Yes" to the question "Are you an agent acting on behalf of the applicant?"

\* Full name

\* Capacity

\* Date  /  /   
dd mm yyyy

[Add another signatory](#)

Once you're finished you need to do the following:

1. Save this form to your computer by clicking file/save as...
  2. Go back to <https://www.gov.uk/apply-for-a-licence/premises-licence/northumberland/apply-1> to upload this file and continue with your application.
- Don't forget to make sure you have all your supporting documentation to hand.

**IT IS AN OFFENCE LIABLE TO SUMMARY CONVICTION TO A FINE OF ANY AMOUNT UNDER SECTION 158 OF THE LICENSING ACT 2003, TO MAKE A FALSE STATEMENT IN OR IN CONNECTION WITH THIS APPLICATION**

**IT IS AN OFFENCE UNDER SECTION 24B OF THE IMMIGRATION ACT 1971 FOR A PERSON TO WORK WHEN THEY KNOW, OR HAVE REASONABLE CAUSE TO BELIEVE, THAT THEY ARE DISQUALIFIED FROM DOING SO BY REASON OF THEIR IMMIGRATION STATUS. THOSE WHO EMPLOY AN ADULT WITHOUT LEAVE OR WHO IS SUBJECT TO CONDITIONS AS TO EMPLOYMENT WILL BE LIABLE TO A CIVIL PENALTY UNDER SECTION 15 OF THE IMMIGRATION, ASYLUM AND NATIONALITY ACT 2006 AND PURSUANT TO SECTION 21 OF THE SAME ACT, WILL BE COMMITTING AN OFFENCE WHERE THEY DO SO IN THE KNOWLEDGE, OR WITH REASONABLE CAUSE TO BELIEVE, THAT THE EMPLOYEE IS DISQUALIFIED**

**OFFICE USE ONLY**

Applicant reference number	<input type="text" value="RXA.HOL356.1"/>
Fee paid	<input type="text"/>
Payment provider reference	<input type="text"/>
ELMS Payment Reference	<input type="text"/>
Payment status	<input type="text"/>
Payment authorisation code	<input type="text"/>
Payment authorisation date	<input type="text"/>
Date and time submitted	<input type="text"/>
Approval deadline	<input type="text"/>
Error message	<input type="text"/>
Is Digitally signed	<input type="checkbox"/>

[1](#) [2](#) [3](#) [4](#) [5](#) [6](#) [7](#) [8](#) [9](#) [10](#) [11](#) [12](#) [13](#) [14](#) [15](#) [16](#) [17](#) [18](#) [19](#) [20](#) [21](#) [Next >](#)



to any information the management or staff become aware of particularly information supplied by Northumbria Police.

- 12. An incident log (electronic or paper based) is to be kept and maintained on the premises. This shall be kept at the premises for at least 6 months and made available to Trading Standards, Licensing Authority and a Police Officer or representative of Northumbria Police on request. The following incidents will be recorded including pertinent detail.**

- 1. Seizure of drugs or other illegal item**
- 2. All crimes reported to the venue or by the venue to the Police.**
- 3. All ejection of patrons**
- 4. Any incidents of disorder**
- 5. Any faults in the CCTV system.**

- 13. The operator shall ensure that at all times when the premises are open for any licensable activity there is sufficient trained, competent staff on duty at the premises for the purposes of fulfilling the requirements of the Licensing Act 2003 and for promoting the licensing objectives.**

- 14. The Designated Premises Supervisor shall ensure that there are effective management arrangements in place to enable him/her to know how many people there are in the premises at times prescribed within the risk assessment.**

- 15. Overnight security staff will remain on site as a protective and crime prevention measure.**

- 17 Stewards will be in place to manage any points where road access meets foot traffic to ensure both can pass without incident or collision.**

- 18 The licence holder or his representative shall conduct regular assessments of the noise coming from the premises on every occasion the premises are used for regulated entertainment and shall take steps to reduce the level of noise where it is likely to cause a disturbance to local residents. A written record shall be made of those assessments in a log book kept for the purpose and shall include the time and date of checks, the person making them and the results including any remedial action.**

- 19 Noise from amplified live and recorded music arising from regulated entertainment held within the designated premises, shall be inaudible at the boundary of the nearest residential dwellings.**

- 20 The licence holder shall provide clear and legible notices to be displayed at prominent positions adjacent to exits and other circulatory areas requesting patrons to leave the premises having regard to the needs of local residents, in particular emphasising the need to refrain from shouting, slamming car doors and the sounding of car horns.**



## Agreed Conditions

1. A CCTV system shall be installed and maintained in proper working order to the satisfaction of Northumbria Police and the Licensing Authority.
2. Such system shall; Ensure the coverage of all entrances and exits to the licensed premises internally and externally including the rear of the premises and all areas where the sale and supply of alcohol occurs.
3. Provide continuous recording facilities for each camera to a good standard of clarity. Such recordings shall be retained (on disc or otherwise) for a period of 28 days.
4. The CCTV shall be in operation at all times whilst the premises are in use. The system with recording facility and any recordings will be stored in a suitable and secure manner. The CCTV system will display on any recording the correct time and date of the recording.
5. Signs are to be placed externally at the premises indicating to customers that CCTV is in operation on the premises. The signs are to be a minimum of A5 size.
6. A minimum of two staff will be trained in the operation of the CCTV system and be able to download images onto disc or removable storage device. CCTV footage shall be supplied to the Licensing Authority or Northumbria Police or representative on reasonable request.
7. The premises licence holder will operate a Challenge 25 policy whilst the premises are open to the public. This is to be in operation by the bar staff. All members of bar staff shall seek credible photographic proof of age from any person who appears to be under the age of 25 years and is seeking to purchase alcohol. Such credible photographic proof will be a passport, driving licence, or proof of age card carrying the pass logo. In addition military identification cards carrying a photograph and date of birth will also be acceptable for this purpose. If a member of bar staff knows without doubt that a person is over 18 then such a challenge for proof of age will not be necessary.
8. Signage regarding the age challenge policy to be displayed.
9. All members of staff should have adequate training in the Licensing Act 2003 and any subsequent variation.
10. A refusals register (electronic or paper based) is to be kept and maintained on the premises. This shall be supplied promptly to Trading Standards, Licensing Authority and a Police Officer or representative of Northumbria Police on request.
11. The premises licence holder and designated premises supervisor will maintain a risk assessment for the general operation of the premises, in relation to individual bespoke events/key calendar dates and circumstances which potentially may increase the risk of crime and disorder, increase the likelihood of harm to children, undermine public safety and increase the likelihood of public nuisance. They shall also take into account the level of staffing particularly regarding the requirement for SIA registered door staff to be employed at the premises during peak times or bespoke events and whether it is felt necessary that the DPS should be in attendance at the premises. Such assessment must give due cognisance

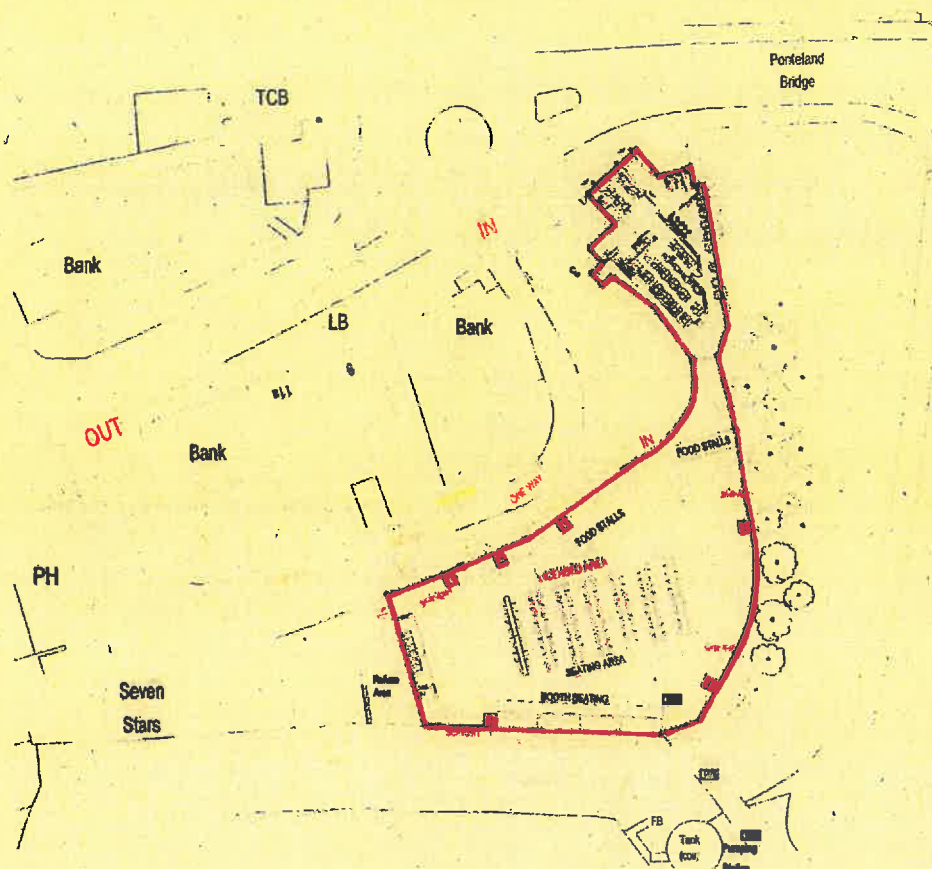

Red Line indicates area where  
 a - Alcohol (will be) is sold;  
 b - regulated entertainment  
 will take place  
 c - hot food or drink after  
 11pm will be supplied

The location and type of any  
 fire safety and other fire  
 safety equipment is shown as  
 it is at present. This may be  
 varied from time to time with  
 the agreement of the fire  
 officer or after fire risk  
 assessment

-  Extinguisher
-  Fire Blanket
-  Escape Route

<p>ALL INFORMATION IS TO          BE KEPT IN THE          FILED IN THE          OFFICE OF THE          FIRE OFFICER          AT THE          FIRE OFFICE</p>	
<p>DATE: 1/10/01          TIME: 10:00          BY: [Signature]</p>	
<p>DATE: 1/10/01          TIME: 10:00          BY: [Signature]</p>	
<p>DATE: 1/10/01          TIME: 10:00          BY: [Signature]</p>	
<p>DATE: 1/10/01          TIME: 10:00          BY: [Signature]</p>	



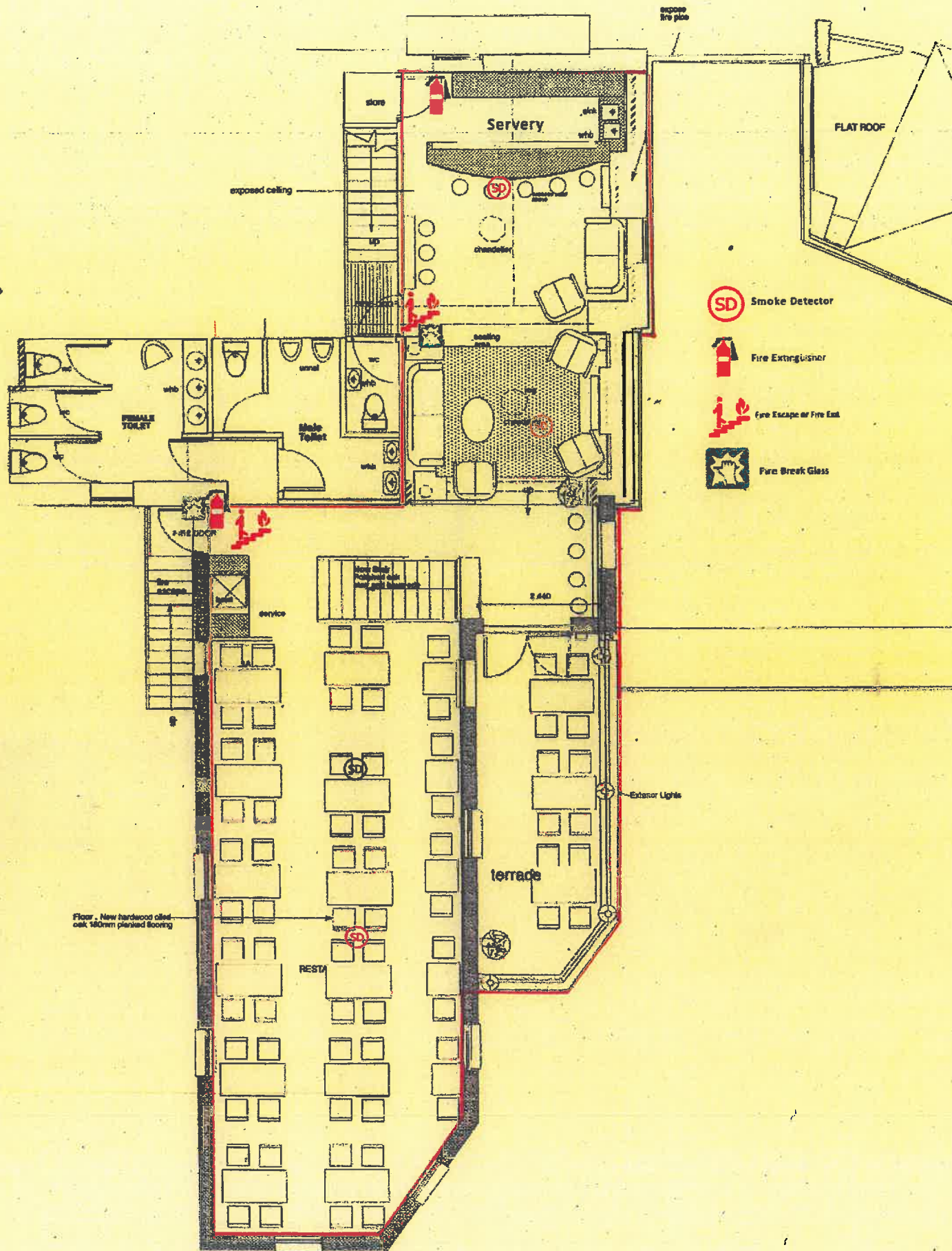

Rialto's First Floor Plan

### Applicants' Note

We have become very aware that our proposal is being, deliberately we think, misrepresented and that this has caused concern in the village.

We would like to take this opportunity to address some of the misleading claims that are circulating.

Firstly, the suggestion that we would intend accommodating up to 800 customers is entirely false. We calculate that our maximum capacity would be around 350 and we would be happy to adopt a condition restricting us to that number. In reality, however, we anticipate trading well below that number.

There has been much criticism of the conditions that we have submitted with our Application. They were provided to us by the Police and we were happy to agree with them (hence the reference to "Agreed Conditions"). We have been in discussion with the Police, the Local Authority, the Town Council and the Fire Service over many months, and we have met with them to explain our proposal. As a consequence, we have had no objection from the Police, Environmental Health, the Fire Service or the Licensing Authority.

We have absolutely no desire to operate a "Stack" type premises catering for stags and hens as is being suggested. Nor do we have any interest in building a "festival" site. The external area will be called The Orchard and we have taken our inspiration from Altringham Market in Cheshire. We have been saddened that so many of our local businesses have been taken over by large companies from outside the area. Our proposal would create facilities for small local independent businesses and provide them with the chance to establish themselves. We propose that the food stores will be occupied by a bakery, a coffee shop, a vintage sweet retailer and a small artisan craft business ( or similar businesses ), as well as there being food providers. We are very aware that we are in a conservation area and we would like to create an old fashioned but modern market square which can accommodate fayres, whether they be craft or farmer style markets and a Christmas fayre.

We have applied for live music as a licensable activity but would not be hosting bands. Live music outdoors will end at 8.30pm Monday to Thursday and 9.30pm on Friday, Saturday and Sunday and will comprise of street type entertainment. Any provision of music would be, however, subject to the inaudibility condition suggested to us by the Police. Mention has been made in several objections of us applying for recorded music until midnight. Whilst this is correct in relation to indoors only, Rialto's existing Premises Licence currently allows the provision of recorded music to any time so, we could, should we have wished, already provide recorded music beyond midnight. In reality, we are not applying for something that we can't already do in terms of indoors and recorded music.

Bearing the above in mind, and what we actually intend doing, we do not anticipate the huge influx of vehicular traffic that is feared. The majority of our patrons will be locals and will arrive by foot, meaning also that we do not need extensive parking provisions. Whilst we have described an area on our plan as a taxi rank that would probably have been better described as a drop off point, meaning that cars won't, as they do now in any event, pull up on the road.

Both Suny and his family, and myself have traded in the village for 35 years and have absolutely no desire to do anything that wouldn't be of benefit to our community. We think that what we propose will be an enormous asset and will provide opportunities for new local businesses to establish themselves, and for there to be a new focus for residents to socialise in a relaxed and family friendly atmosphere.

